

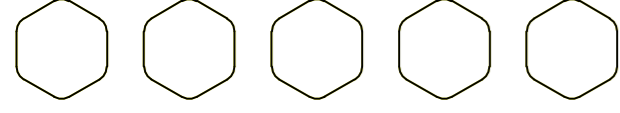

© BBC Studios and Post Production Ltd 2010  
 This drawing may not be copied or reproduced without  
 the permission of BBC Studios and Post Production Ltd.  
 Issued January 2010. All previous versions superceded.

**LIGHTING\_OUTLETS\_AVAILABLE**



Unknown @ 26/09/07

**KEY\_TO\_SYMBOLS**

- CAMERA CONNECTION
- FIRE EXTINGUISHER
- TECHNICAL WALL BOX - SOUND & VISION
- HOUSE LIGHT SWITCH
- LIGHTING TRUSS
- CYC RAIL
- HEIGHT OF LIGHTING TRUSS 4.8 METERS

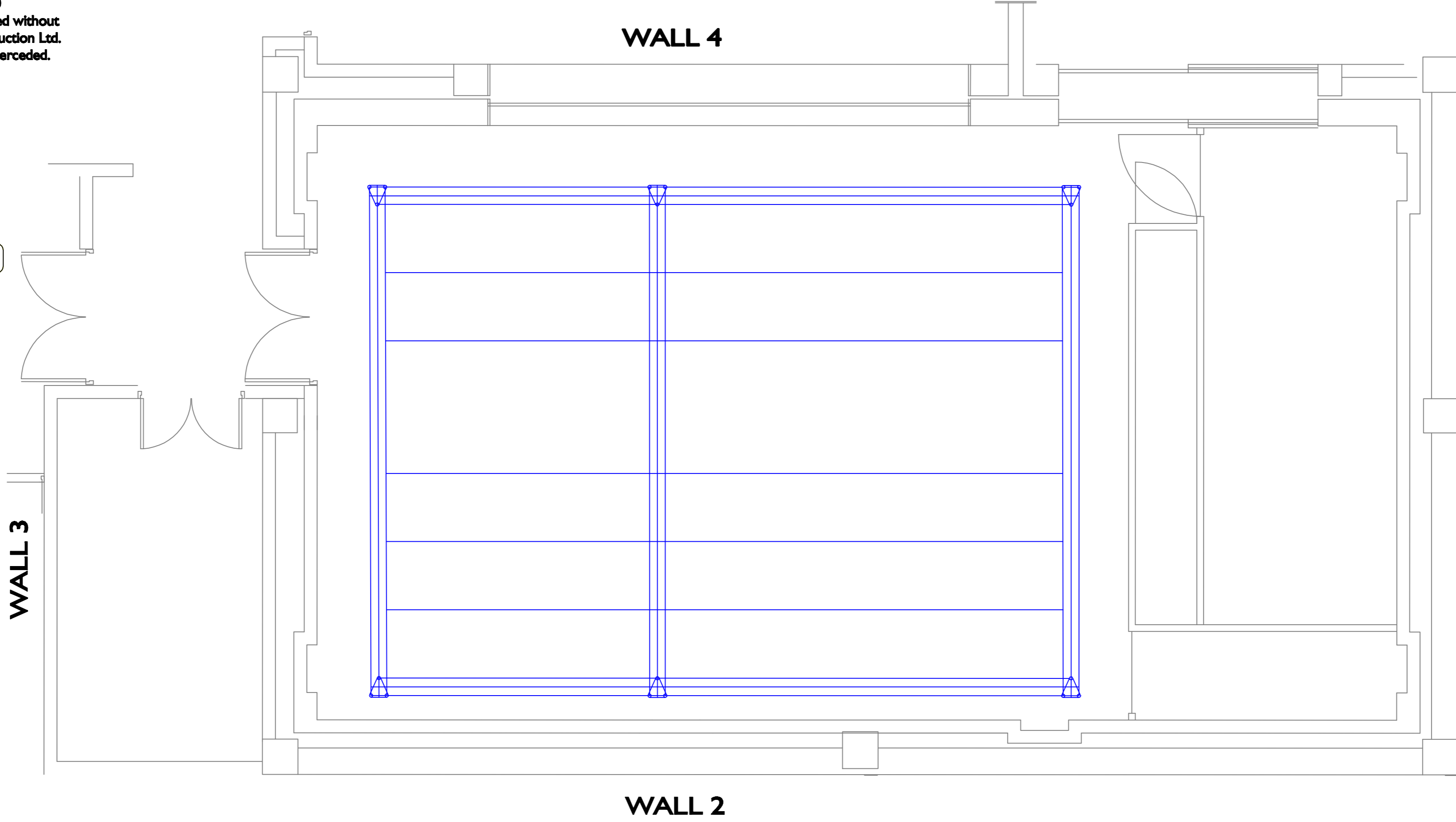

<b>LIGHTING &amp; FLOOR PLAN</b> SCALE 1:50 @ A2
<b>T C O</b>
<b>PRODUCTION</b>
<b>DIRECTOR</b>
<b>DESIGNER</b>
<b>ZERO DATE</b>
<b>LIGHTING</b>

Duty Studio Co-Ordinator - 24hr - 67077  
 Lighting workshop - 68469  
 Mechanical Workshop - 63252  
 Production Store - 63258

