







© BBC Studios and Post Production Ltd 2010
 This drawing may not be copied or reproduced without the permission of BBC Studios and Post Production Ltd.
 Issued January 2010. All previous versions superceded.

LIGHTING OUTLETS AVAILABLE

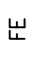
Unknown @ 26/09/07

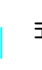
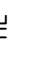
KEY TO SYMBOLS

-  CAMERA CONNECTION
-  FIRE EXTINGUISHER
-  TECHNICAL WALL BOX - SOUND & VISION
-  HOUSE LIGHT SWITCH
-  LIGHTING TRUSS
-  CYC RAIL
-  HEIGHT OF LIGHTING TRUSS 4.8 METERS

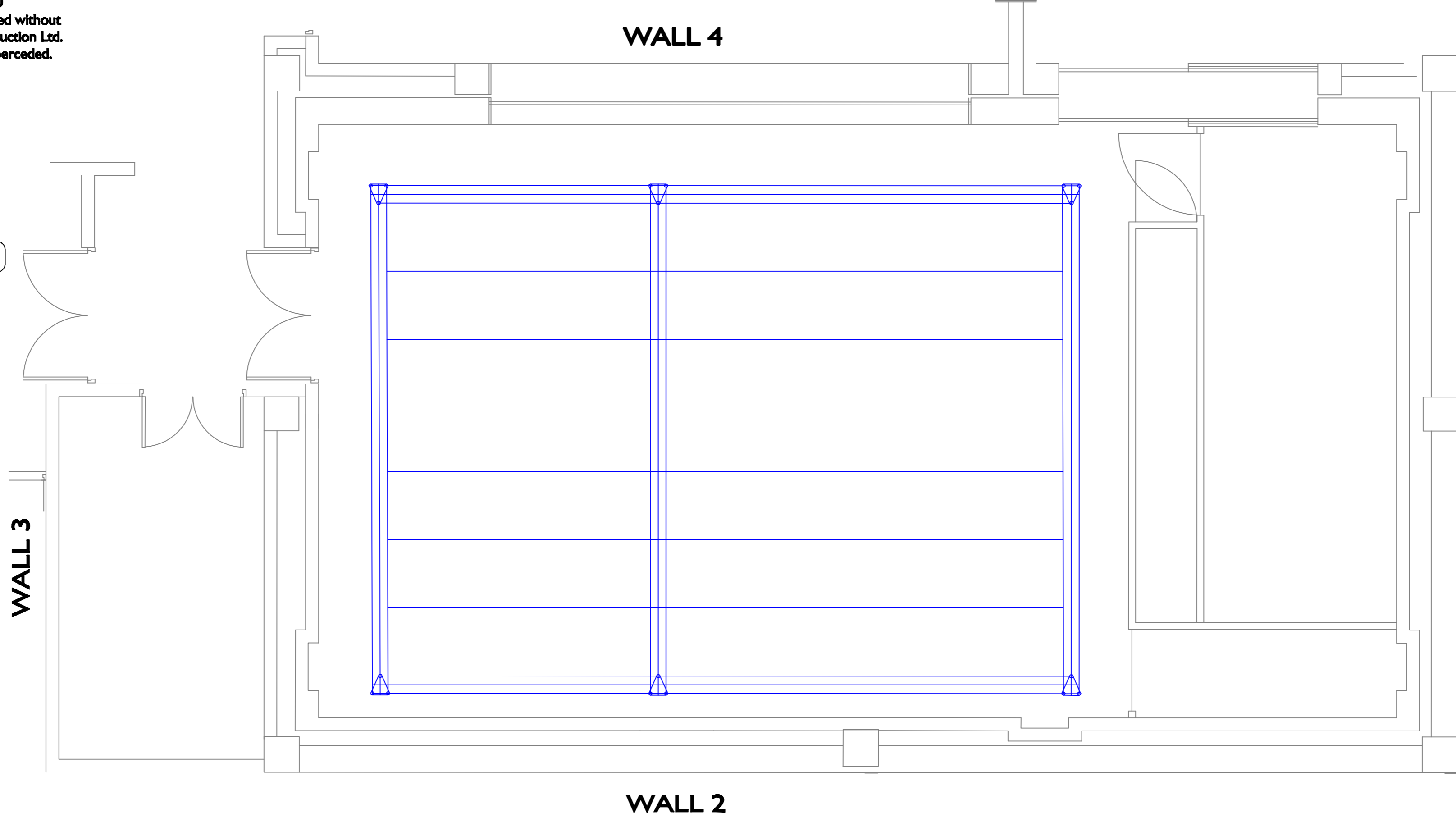
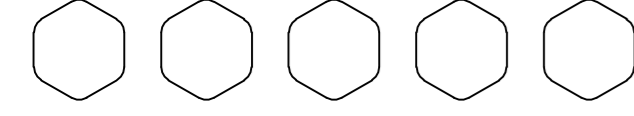

LIGHTING & FLOOR PLAN SCALE 1:50 @ A2
T C O
PRODUCTION
DIRECTOR
DESIGNER
ZERO DATE
LIGHTING

Duty Studio Co-Ordinator - 24hr - 67077
 Lighting workshop - 68469
 Mechanical Workshop - 63252
 Production Store - 63258

