

# Studio 7

4m to Grid  
7.2m to Apex  
1600 sq ft / 149 sq m

 Truss  
300mm sq section  
H 4m

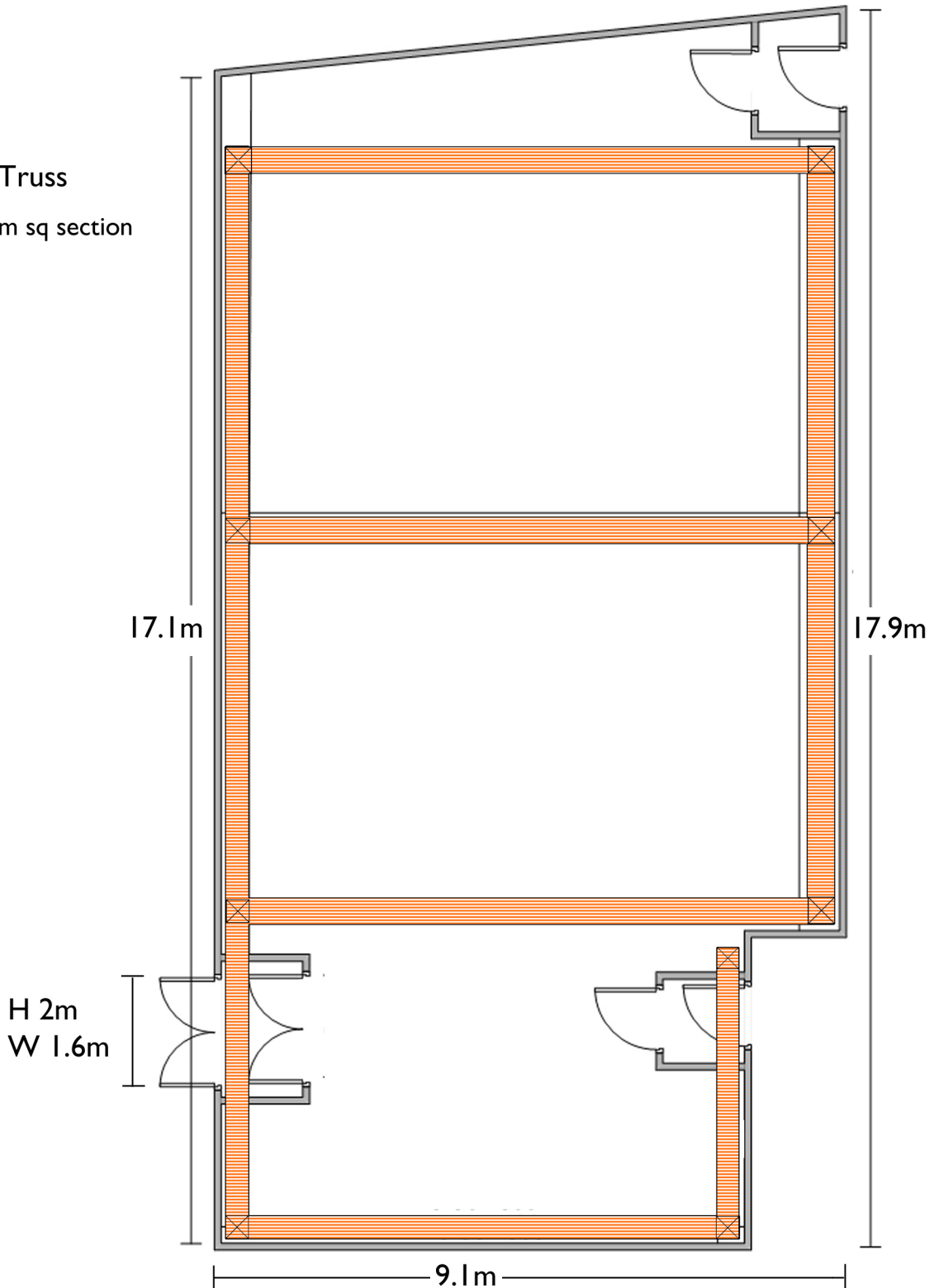

**BBC** Studios and Post Production

© BBC Studios and Post Production LTD 2011  
This drawing may not be copied or reproduced without  
the permission of BBC Studios and Post Production LTD.  
Issued January 2011. All previous versions superceded.

**Paintworks 6.3**  
Bath Road, Bristol, BS4 3EH  
Tel: 0117 300 5445